

USER MANUAL

FULL SIZE ELECTRIC CONVECTION OVEN



MODEL: CV100-208, CV100-240



USR BRANDS INC.

Phone: 800-764-1172 | www.usrbrands.com | sales@usrbrands.com

Please read this manual before operation

Installation & Operation Manual

ELECTRIC CONVECTION OVEN

Potential hazard or unsafe practice could result in minor or moderate injury or product or property damage

FOR YOUR SAFETY

Do not store or use gasoline or other flammable vapors or liquids in the vicinity of this or any other equipment.

 **WARNING Improper installation, adjustment, alteration, service or maintenance can cause property damage, injury or death. Read this installation, operating and maintenance instructions thoroughly before installing or servicing this equipment.**

Dear Customer & User,

Thank you for purchasing our appliance. Before use and operation, please read and familiarize yourself with the following operating and safety instructions. **SAVE THESE INSTRUCTIONS FOR FUTURE REFERENCE.** Save the original box and packaging. Use this packaging to ship the equipment if repairs are needed.

This manual contains important information, please read the manual thoroughly prior to equipment set-up, operation and maintenance. Failure to comply with regular maintenance guidelines outlined in this manual may void the warranty.

The user's manual should be always available for operation. So make sure this manual book is properly placed. We have the full authority to reserve the further technical changes of the device, in the scope of further performance improvement characteristic development.

WARNINGS



WARNING!

This symbol highlights hazards, which could lead to injury. Please follow the instructions very carefully and proceed with particular attention in these cases.



WARNING! Electrical hazard!

This symbol draws attention to potential electrical hazards. If you do not follow the safety instructions, you may risk injury or death.



CAUTION!

This symbol highlights instructions, which should be followed to avoid any risk of damage, malfunctioning, and/or breakdown of the device.



NOTE! This symbol highlights tips and information, which have to be followed for efficient and trouble-free operation of the device.



WARNING! Hot surface! This symbol is a warning that the device surface is hot when in use. Ignoring this warning may result in burns!

- every chapter provides precise safety advice for the prevention of dangers which are highlighted by the use of the above mentioned symbols. Furthermore, attention should be paid to all pictograms, markers, and labels on the device, which must be kept in a permanent state of legibility. By following all the important safety advice you gain optimal protection against all hazards as well as the assurance of a safe and trouble-free operation.
- This device is designed in accordance with the presently applicable technological standards. However, the device can pose a danger if handled improperly and inappropriately.
- Knowing the contents of the instruction manual as well as avoiding mistakes and thus operating this device safely and in a fault-free manner is very essential to protecting from hazards.
- To prevent hazards and to ensure optimum efficiency, no modifications or alterations to the device that are not explicitly approved by the manufacturer may be undertaken. This device may only be operated in technically proper and safe conditions.
- If the device is used commercially, the user is obliged to ensure that the said

industrial safety measures concur with the state of the rules and regulations applicable at the time in question for the entire period of use of the device and to comply with the new specifications.

- Users must comply with the industrial safety laws applicable at the place of installation of the device and the regional territorial provisions. Besides the industrial safety instructions in the instruction manual, users must also follow and comply with the general safety and accident prevention regulations as well as environment protection regulations applicable for area of application of the device.
- Please keep these instructions and give them to future owners of the device.
- All people using the device should follow the instructions and tips contained in these instructions.
- Only use the device indoors.

Product parameters table

Model No.	Dimension(inch)	Voltage	Phases	Rated power (BTU/Hr.)
CV100-208	38.11*40.59*54.07	208V	1	9KW
CV100-208	38.11*40.59*54.07	208V	3	9KW
CV100-240	38.11*40.59*54.07	240V	1	11KW
CV100-240	38.11*40.59*54.07	240V	3	11KW

Product Structure

Single deck oven

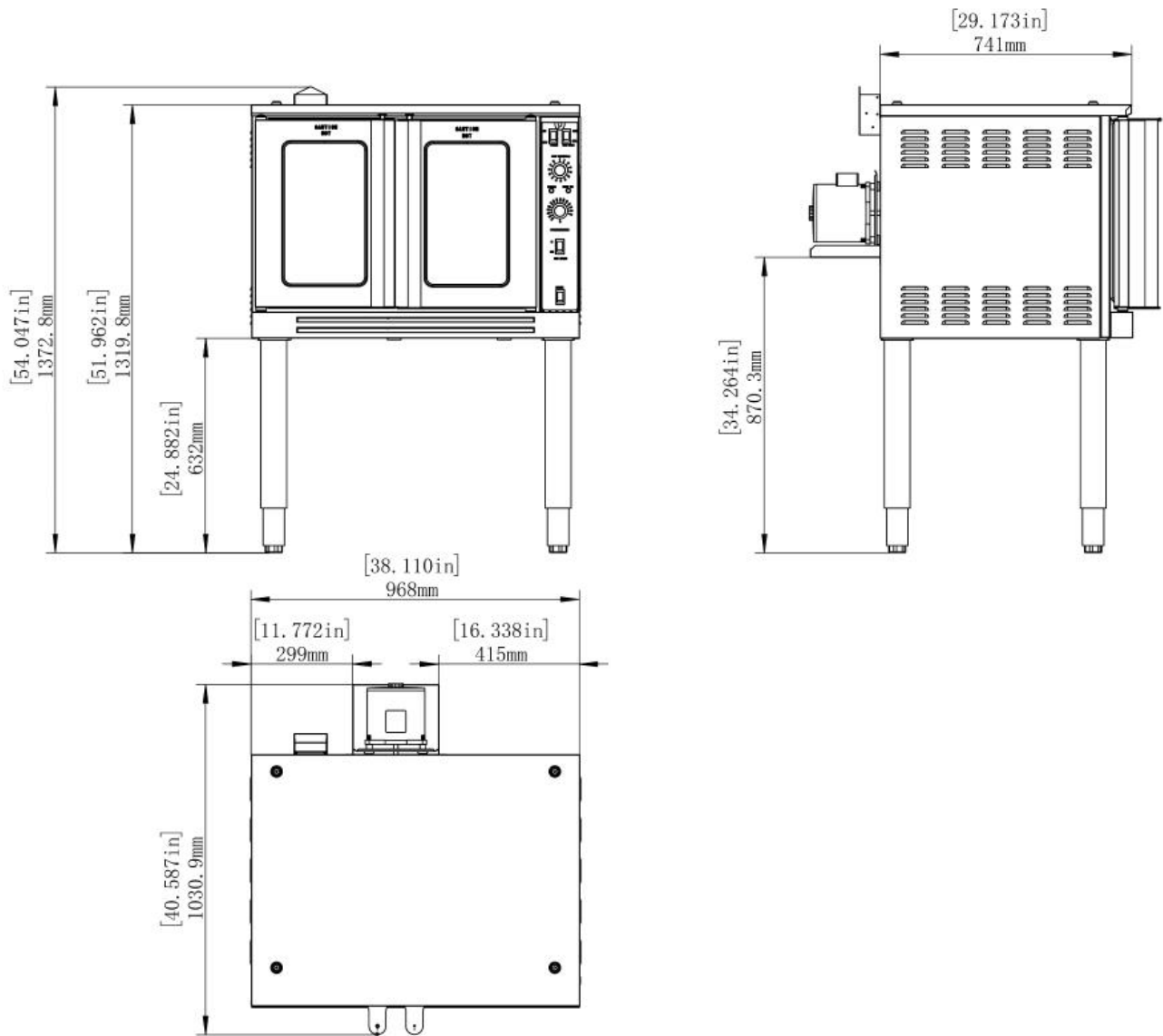

Double deck oven

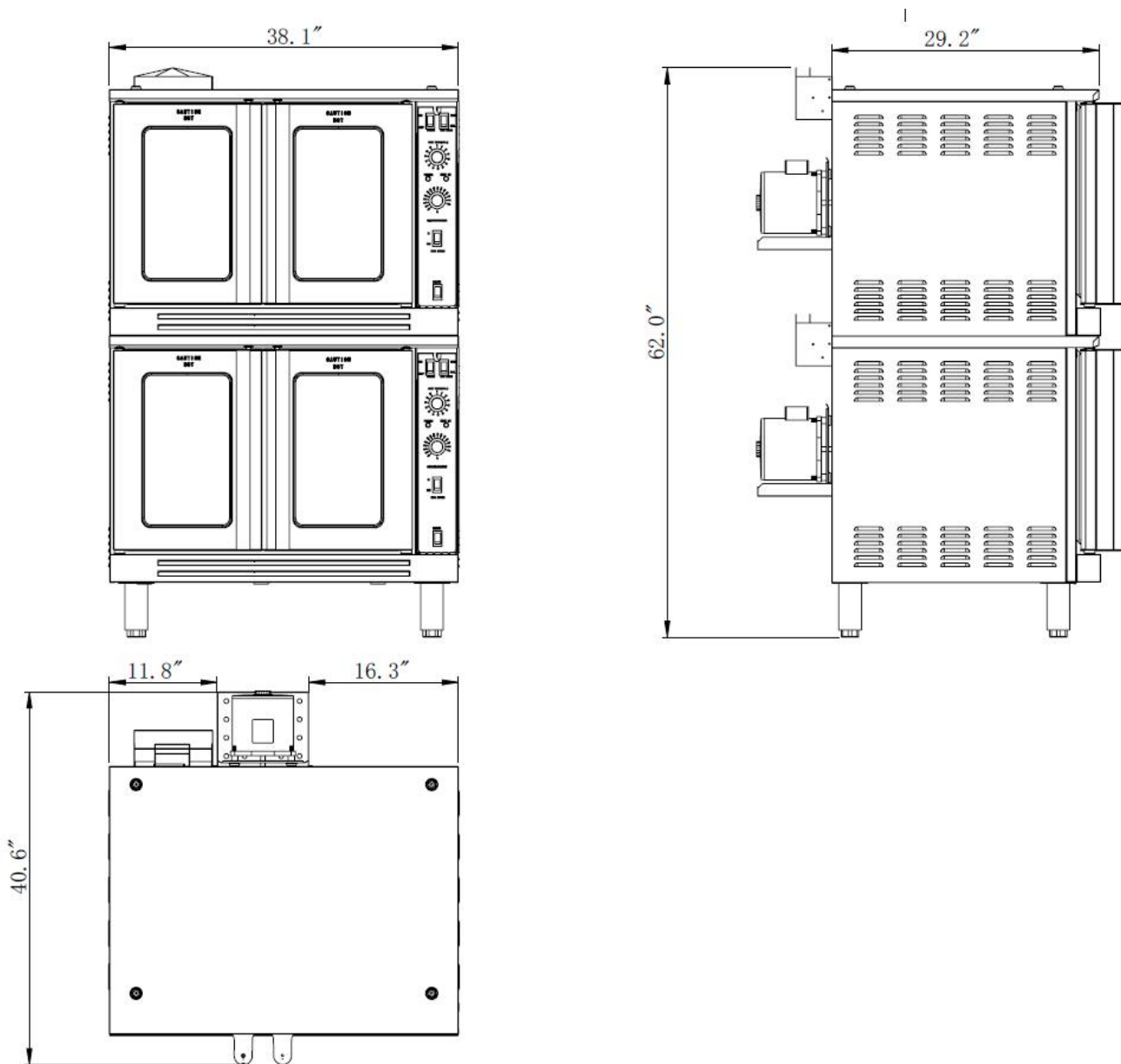

Stacking oven instruction:

Requires two ovens and stacking kit

Note: We recommended that the stacking is performed by authorized service

agent or installer.

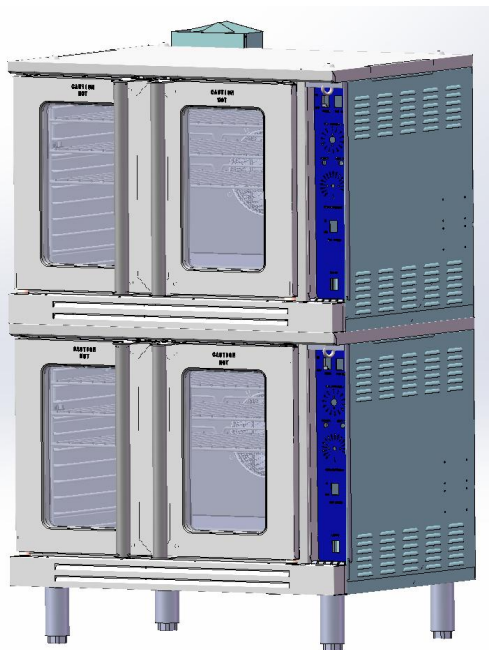

Step1:

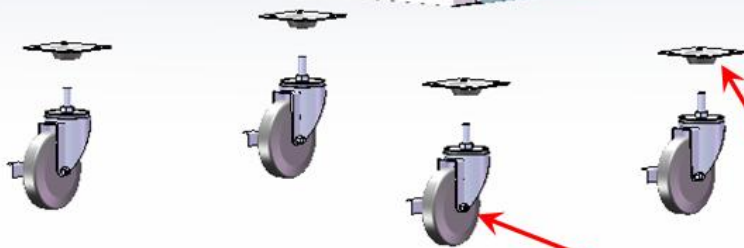
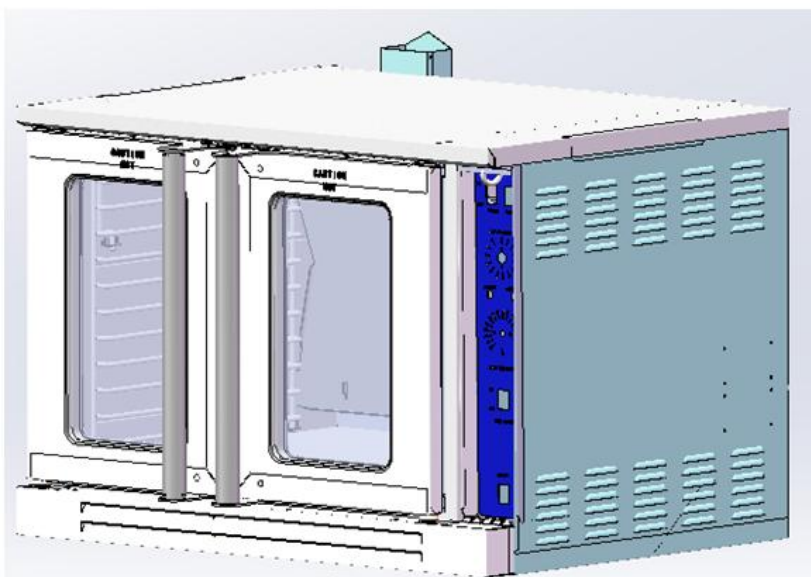

1. Install the fixer kit and fasten ←
With bolts ←



2. Install the legs or casters ←

USR BRANDS® RESERVES THE RIGHT TO CHANGE SPECIFICATIONS WITHOUT NOTICE

Step2:

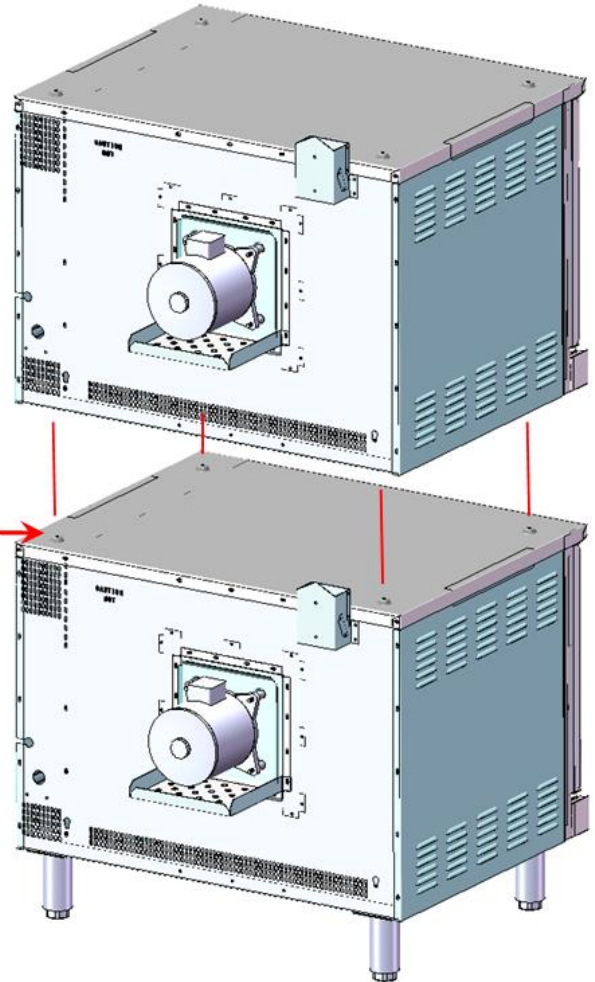

Align the top protrusion of the bottom oven with the corresponding notch of the above oven ←

Step3:

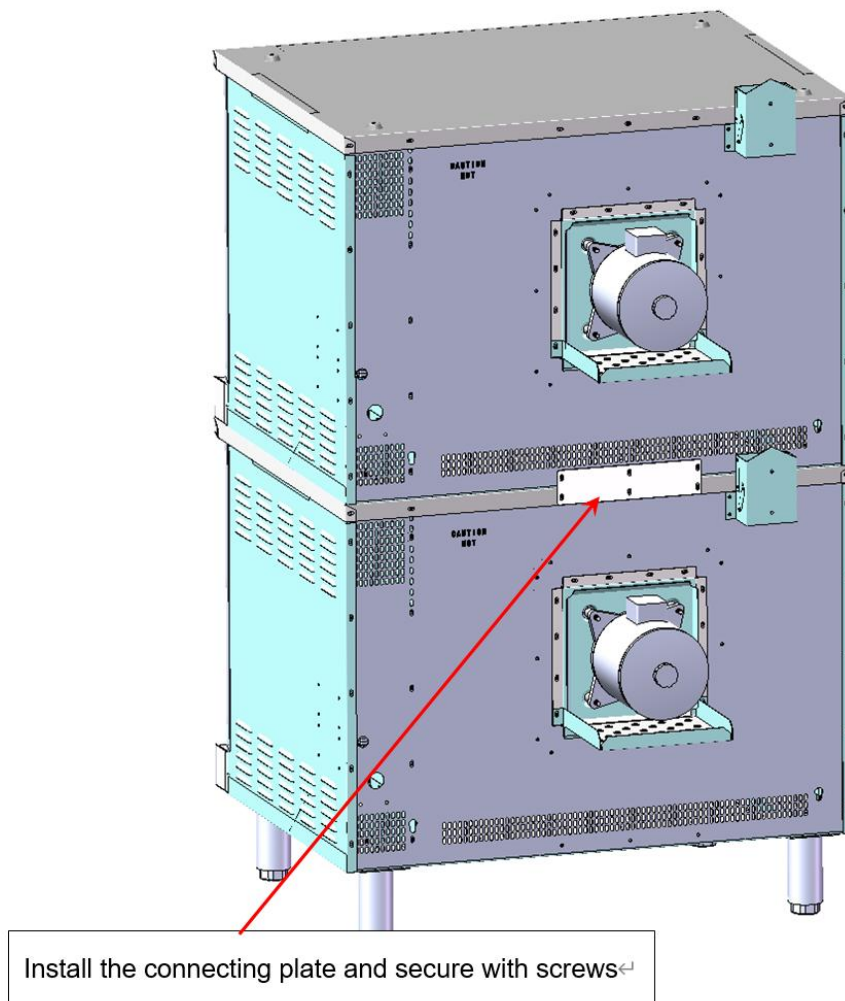

INSTALLATIONS

TO INSTALL:

1. Remove unit from box and make sure all plastic, tape and packing materials are removed.
2. Place the unit on a flat, secure surface
3. Install the leg onto the unit and make sure the unit is level
4. The connections to the electric network must be close to the equipment and easy to reach.
5. Unit should be placed under a ventilation hood and there should be at least 2” of space between

the back of the oven and the wall. This will ensure proper airflow

6. Law provisions, technical regulations, and directives: The manufacturer requires the installation to be performed according to national and local codes.

7. Checking the functions: Before connecting the equipment to the network, check the following:

- Network voltage corresponds to the data written on the plate
- Grounding is efficient
- The connection cable is suitable to the power absorbed by the equipment

8. Notes for the installer:

- Explain and demonstrate to the user how the equipment works according to the instructions, and ensure that the user manual is accessible.
- Remind the user that any structural alterations or modifications made to the room of house, the equipment will warrant a recheck of the equipment functions.
- Do not install the equipment close to other units that can reach high temperature, as the electrical components could be damaged. A 6" minimum clearance is required from such equipment.

9. Room Ventilation:

- The room where the equipment is installed must be fitted with air intakes to guarantee the correct operation of the unit and air exchange.
- During installation, make sure the air suction and evacuation ways are free from any obstruction

Clearance and positioning around the equipment:

Install the unit at least 2" from the wall and at least 6" from other heat-producing equipment. Any wall, surface, cabinet, table, etc. in close proximity to the equipment should be made of non-combustible materials with proper thermal insulation.

Oven With Optional Casters Accessory: (Restraining device does not come supplied with oven or casters).

- a) Adequate means must be provided to limit the movement of the appliance without depending on or transmitting stress to the electrical conduit.
- b) The restraining device should be attached to cutout on the back panel. See below illustration .
- c) The appliance shall be installed using flexible conduit.

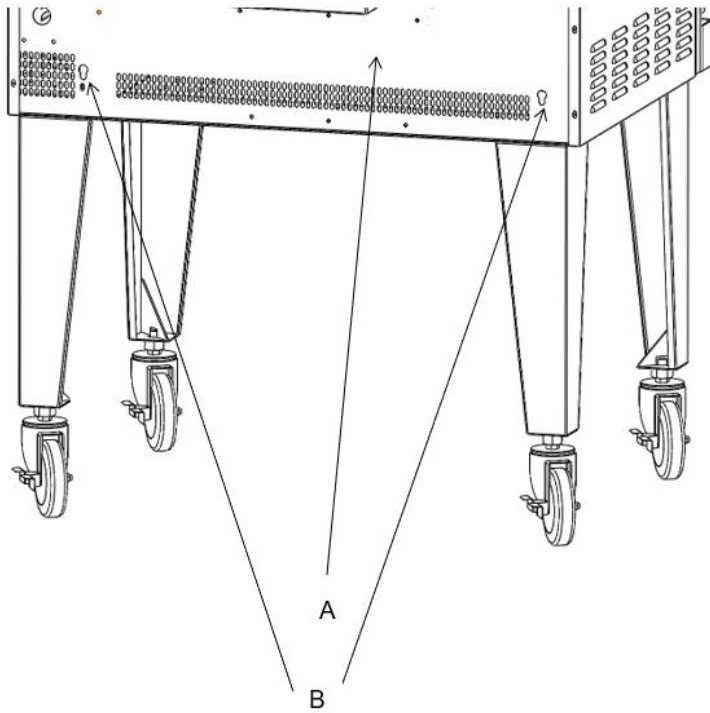

A: Back panel

B: Strain relief chain connection

(chain supplied by others)

ELECTRIC CONNECTION:

The oven must be electrically grounded in accordance with all local and national codes (In the USA the National Electrical code ANSI/NFPA no. 70 is applicable).

WARNINGS:

1. Always ensure proper supervision while the equipment is in use.
2. Simple adjustments to knobs, leg height, etc. do not require assistance from specialized personnel. For more technical adjustment ,please consult the qualified technician.
3. Use only parts and accessories recommended by manufacturer.
4. During the initial uses of the equipment, an acrid or burning smell may be detected.This will disappear after two or three uses.
5. The equipment will remain hot for a short time after use (residual heat). Avoid all physical contact with the unit during this time to prevent injury.
6. This equipment is strictly for professional use and must be used by qualified personnel.
7. The installation start up,and maintenance of this equipment must be carried out by a qualfed technician.

8. All installation must be carried out according to the law. Manufacturer is not responsible for damages due to an incorrect installation, improper maintenance, or incorrect use.
- These are very important regulations; if they are neglected, the equipment may not perform properly or the user may be placed at risk and void manufacturer warranty.

OPERATING INSTRUCTIONS AND CONTROLS:

Control panel features

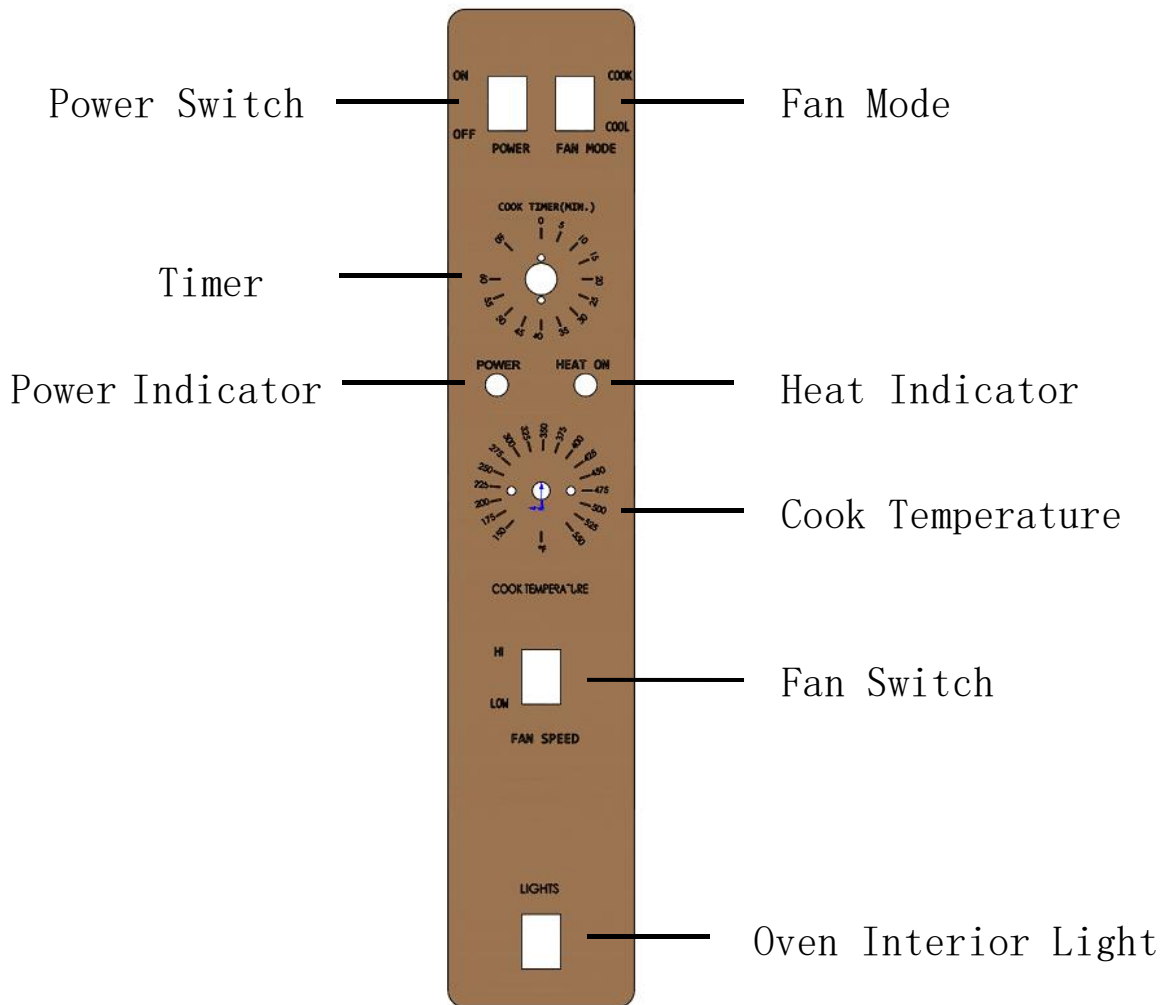

To Use :

1. Turn the oven ON by using the power switch at the top of the control panel.
2. Select the desired fan speed using the fan speed switch, the appropriate fan speed (Hi or Low) depend on the food being cooked.
3. Switch the Fan Mode to Cook. In cook mode, the fan will run continuously when the oven doors are closed (The fan does not cycle on and off with the heating element). If the switch is set to COOL, the fan will continue to run even with the doors open.
4. Set the cooking temperature by turning the Cook Temperature Control until the indicator mark on the knob is pointed to the desired cooking temperature. The HEAT ON indicator will light when the heating element is on and will remain on while the oven pre-heats.
5. The HEAT ON indicator will turn on and the oven will be heated, wait until the HEAT ON indicator turn off then the oven will have reached the set cooking temperature.
6. Set the fan mode to cook mode then open the oven doors and load the product into the oven. Once product is set, close oven doors to start cooking.
7. To set the Timer turn the Cook Timer until the indicator mark points to the desired cooking time. The timer goes from 0-60 minutes. A buzzer will buzzing once the timer hits 0. The buzzer will shut off after turn to OFF position. The timer does not control the oven. The timer will continue to run when the oven doors are open.
8. When the food is done cooking, you can quickly cool it down by opening the oven doors and switching the fan mode to COOL with HI speed.
9. When you are done cooking, turn the oven off by turning the temperature to the lowest setting and switching the Power Switch to OFF.

CLEANING & MAINTENANCE

To maintain cleanliness and increase service life, this item should be cleaned daily. Do not immerse the unit in water or any other liquid, if liquid enters the electrical compartment it may cause a short circuit or electrical shock.

1. Before cleaning or attempting to move this item, turn off the unit, and let it cool down.
2. Wipe the entire unit with a clean soft cloth until it is completely dry.
3. To avoid damage to the unit, do not use abrasive cleaners or scouring pads.
4. If soap or chemical cleaners are used, be sure they are completely rinsed away with clean water immediately after cleaning and dry carefully with cloth. Chemical residue could damage or corrode the surfaces of the unit.

To avoid serious injury or damage, never attempt to repair or replace a damaged power cord yourself. Contact a professional repair service.

5. Before carrying out any maintenance or repair, disconnect the equipment from the mains. Use only original spare parts supplied by manufacturer.
6. If the equipment is not going to be used for a long period of time, it is advised to clean the equipment and surrounding areas properly. Pour a small quantity of cooking oil on the stainless steel surfaces, carry out all maintenance operations, and cover the equipment with a suitable material, leaving some space for air to circulate.

Failure Analysis & Trouble Shooting:

Problem	Possible Causes	Solution
No Heat	Heating element defective	Call authorized service center
No Heat	Power switch on control panel is off	Set the control panel to COOK
No Heat	Doors are open	Close doors
No Heat	Door micro switch defective	Call authorized service center
Oven do not reached proper temperature	The oven has not reached pre-heat temperature	Wait for oven to reach pre-heat temperature

Oven do not reached proper temperature	Internal problem with main temperature control	Call authorized service center
Convection fan does not run	Oven has no electrical power	Check electrical supply
Convection fan does not run	Circuit breaker tripped	Reset the breaker
Convection fan does not run	Doors are open	Close doors
Convection fan does not run	Door Micro-switch defective	Call authorized service center

Helpful Hints:

Problem	Possible Causes	Solution
Food browns unevenly	Improper heating temperature	Pre-heat until desired temperature is reached
Food browns unevenly	Baking pan dark or glass	Lower oven temperature by 25° F
Food browns unevenly	Too much food or trays or racks	Recommend place three racks evenly
Food dries before browning	Oven temperature too high	Lower oven temperature

Wiring diagram for the electric convection oven

1 phase:

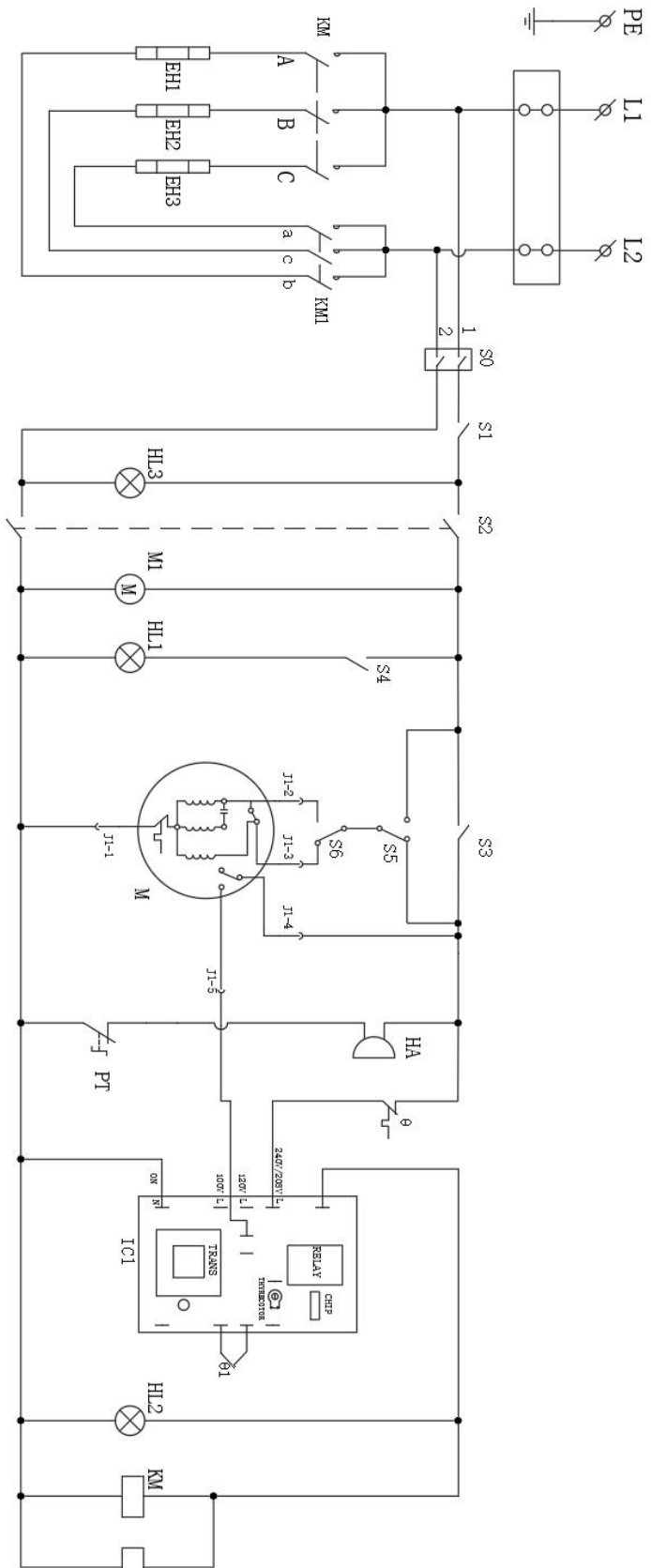

USR BRANDS® RESEI

KM/KM1	AC contactor	S3	Door switch	HL 1	Interior light
EH1, EH2, EH3	Heating element	S4	Internal light switch	HL2	Heating indicator light
So	Air switch	S5	Cooling switch	HL3	power indicator light
S1	Protection switch of electrical box	S6	Fan switch (Hi/Low speed)	M	Motor
S2	Power switch	PT	Timer	HA	Buzzer
		IC1	Thermostat	θ	Temperature limiter

3 phase:

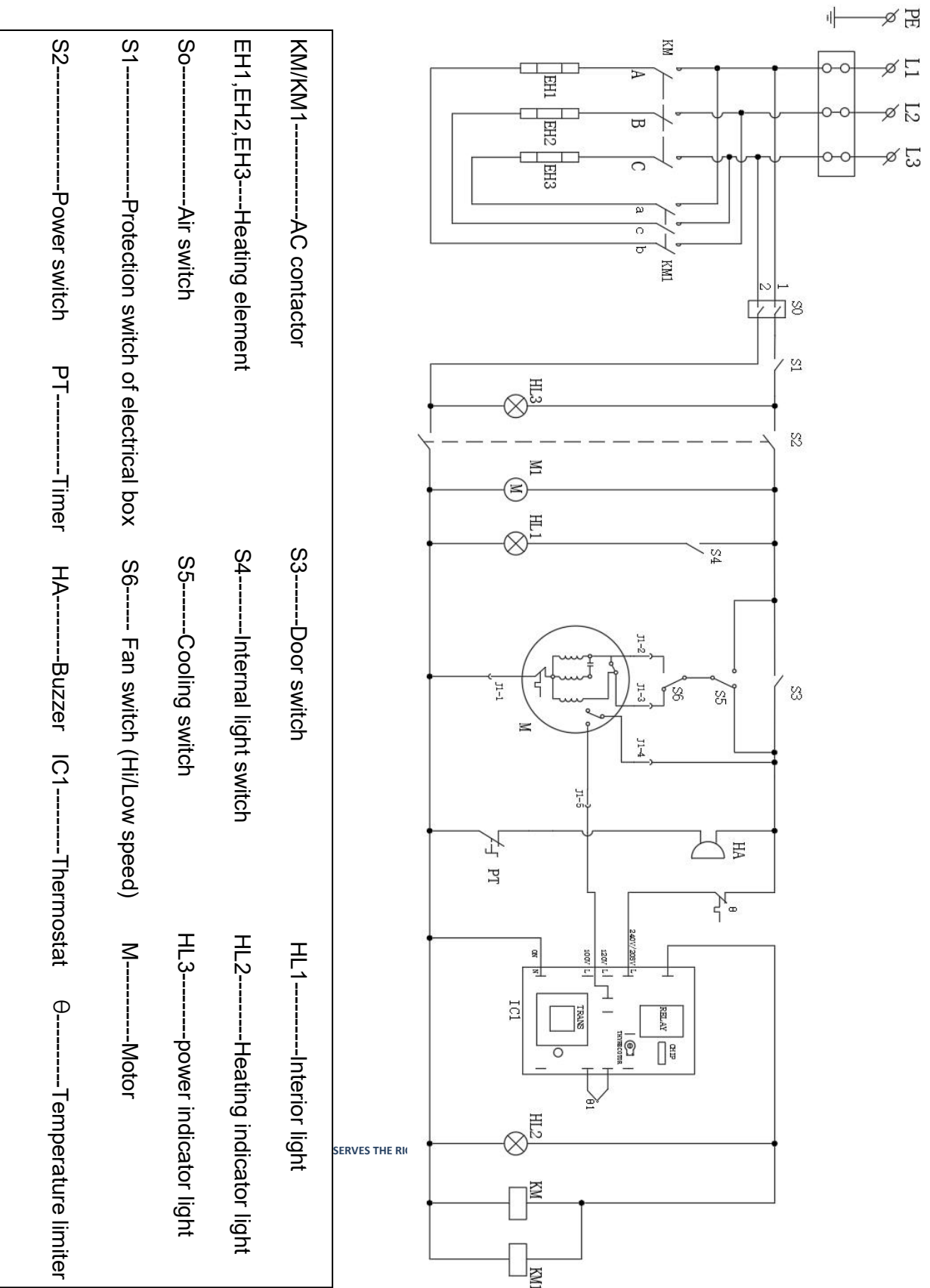

Explosive Drawing

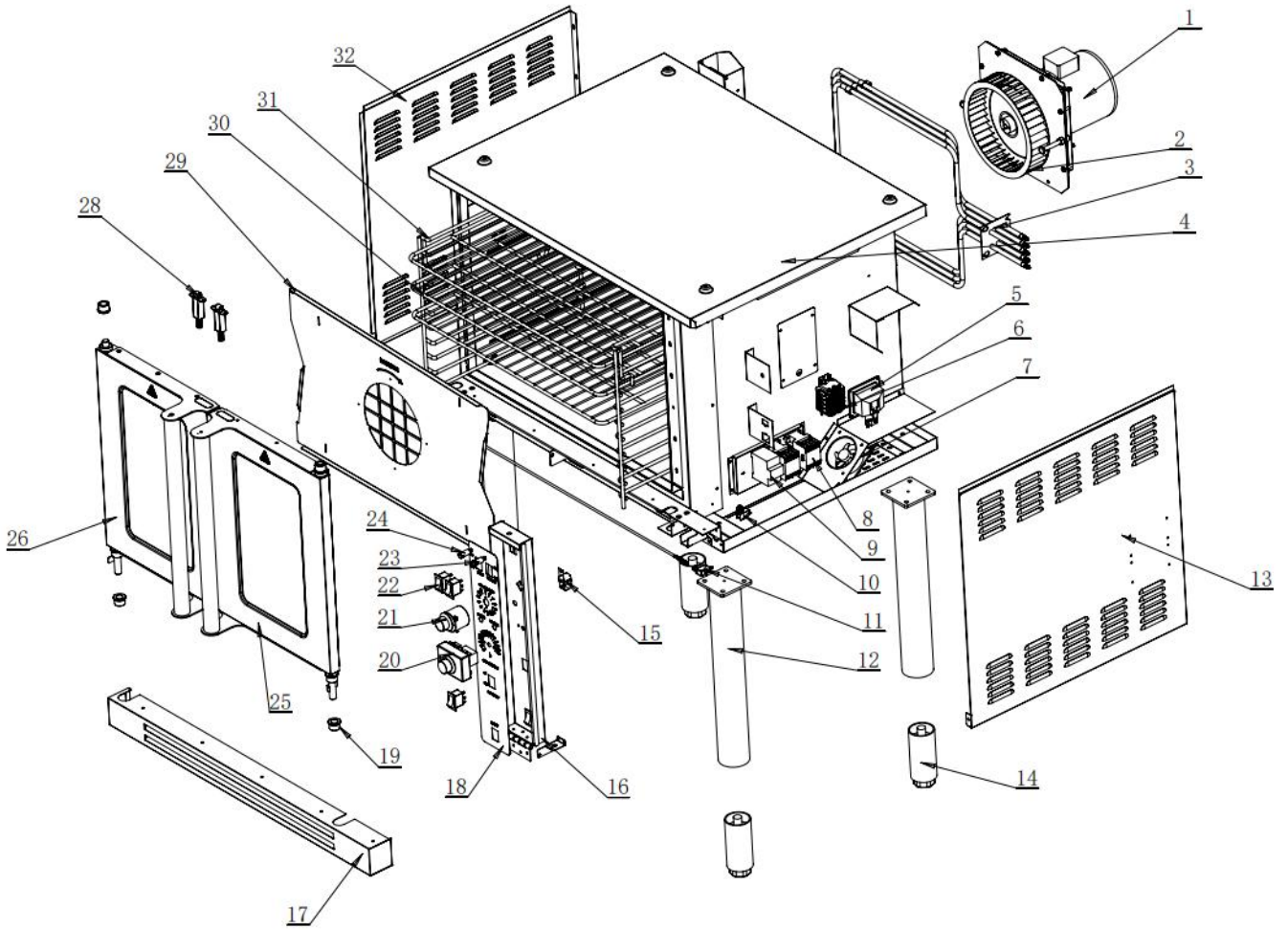

Part List

Item No.	Part Code	Part Description	Qty
1	30101001021	Motor	1
2	30219000012	Turbo Fan	1
3	30104000109	Heating Element	1
4	20147001003	Top Cover Assembly	1
5	30113000050	Chamber Light	1
6	30107000012	Terminal	5
7	30219000043	Cooling Fan	1
8	30110000027	AC contactor	2
9	30109000006	Circuit Breaker	1
10	30108000002	Mirco-Switch	1
11	30108000002	Mirco-Switch	1
12	30209000021	Round leg	4
13	20247001040	Right Side Plate	1
14	30209000009	Adjustable Leg	4
15	30110000023	Buzzer	1
16	20247001012	Control Panel	1
17	20247001023	Front Lower Cover Plate	1
18	30312000112	Red Facial Panel	1

19	30220000023	Door Shaft Bush	6
20	30103000016	Thermostat	1
21	30112000003	Timer	1
22	30108000013	Switch	4
23	30113000044	Heating Indicator	1
24	30113000043	Power Indicator	1
25	20144001009	Right Door Assembly	1
26	20144001012	Left Door Assembly	1
28	20144001014	Door Stopper Assembly	2
29	20447001006	Front Plate of Combustion Chamber	1
30	30211000052	Rack	3
31	30204000019	Rack Support	2
32	20247001021	Left Side Plate	1