

# USER MANUAL

## TRAFFIC DOOR



**MODEL:** PTD3084, PTD3684, PTD6084, PTD7284



USR Brands, Inc.

Phone: 800-764-1172 | [www.usrbrands.com](http://www.usrbrands.com) | [sales@usrbrands.com](mailto:sales@usrbrands.com)

## 1. MAINTENANCE

Regular maintenance of your Traffic Door is crucial for ensuring trouble-free operation. It is recommended to conduct inspections, lubrication, and cleaning every **six** months. Here are some key points to consider:

1. Visual inspection: Check the door(s) and seals for any signs of damage or wear.
2. Gasket examination: Inspect the gaskets for cuts or tears that may affect their sealing ability.
3. Hinge inspection: Ensure that the hinges are securely fastened to prevent any loose attachments.
4. Smooth operation: Test the door to ensure it opens and closes freely without any obstructions or difficulties.
5. Proper alignment: When closed, verify that the door is centered in the opening for optimal functionality.
6. Double door sealing: Ensure that they create a tight seal in the middle when closed.
7. Attachment check: Thoroughly examine any plates, bolts and hinges for any loose attachments that may require tightening.

By following these maintenance practices, you can maximize the performance and longevity of your Traffic Door.

## 2. BEFORE INSTALLATION

Please ensure that the doorway jamb and lintel are checked for plumb and squareness.

It is important to note that the **jamb and lintel** must have a minimum width of 4 1/2 inches and be square and plumb. Additionally, it is crucial that your **construction** is at least double the size of 2" x 4" or an equivalent. For hollow metal jambs, reinforcement at hinge locations is necessary.

## 3. INSTALLATION GUIDE

**Important:** It is advised not to fully tighten the screws or bolts until the door panel has been properly aligned.

### Installation

1. Remove side covers(if installed) and unscrew the 2 nuts and bolts from the upper hinge cam plate.

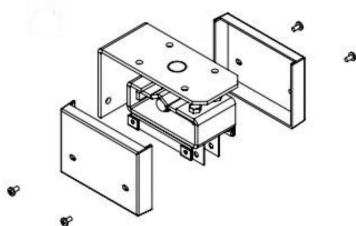

GHT TO CHA



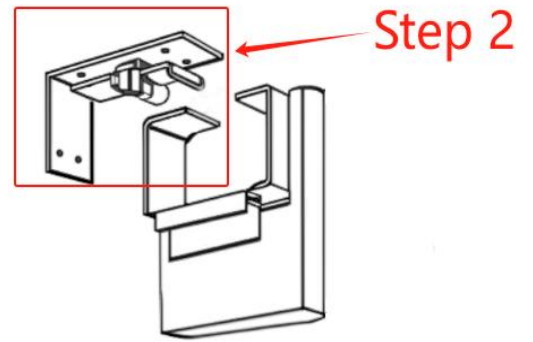

2. Take off the "L" bracket from the upper hinge assembly.

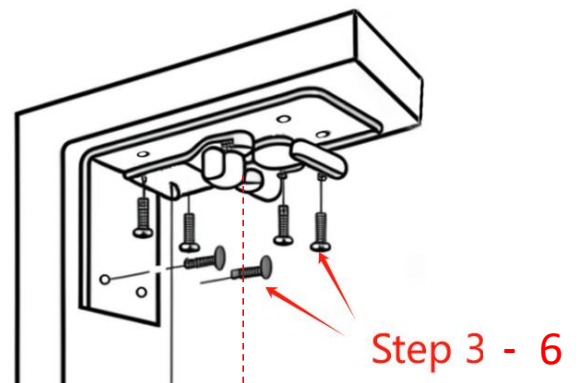

3. Position this L-bracket flush in the upper corner.
4. Mark the 6 mounting holes by using this L-bracket.
5. Drill the 6 holes. 7/32" for steel construction and 3/16" for wood construction.
6. Mount **this L-bracket** with **(6) large cross head bolts (1/4-20\*1)**.  
Make sure the cam is flush.

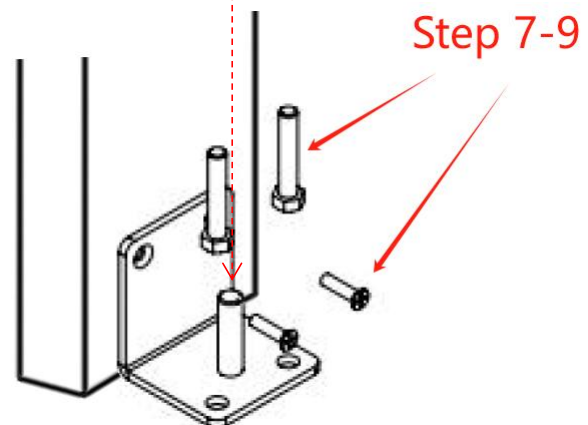

7. Position the lower hinge L-bracket flush in the bottom corner, making sure that the bracket pin is vertically aligned with the top camshaft.
8. Mark and Drill the 4 mounting holes by using the lower hinge pin L-bracket.
9. Insert and screw x**(2) expansion bolts (3/8-16\*2.25)** to mount the lower hinge L-bracket **to the threshold**. Insert and screw the rest **(2) cross head bolts (1/4-20\*1)** to mount it **to the jamb**.

## Step 10-15

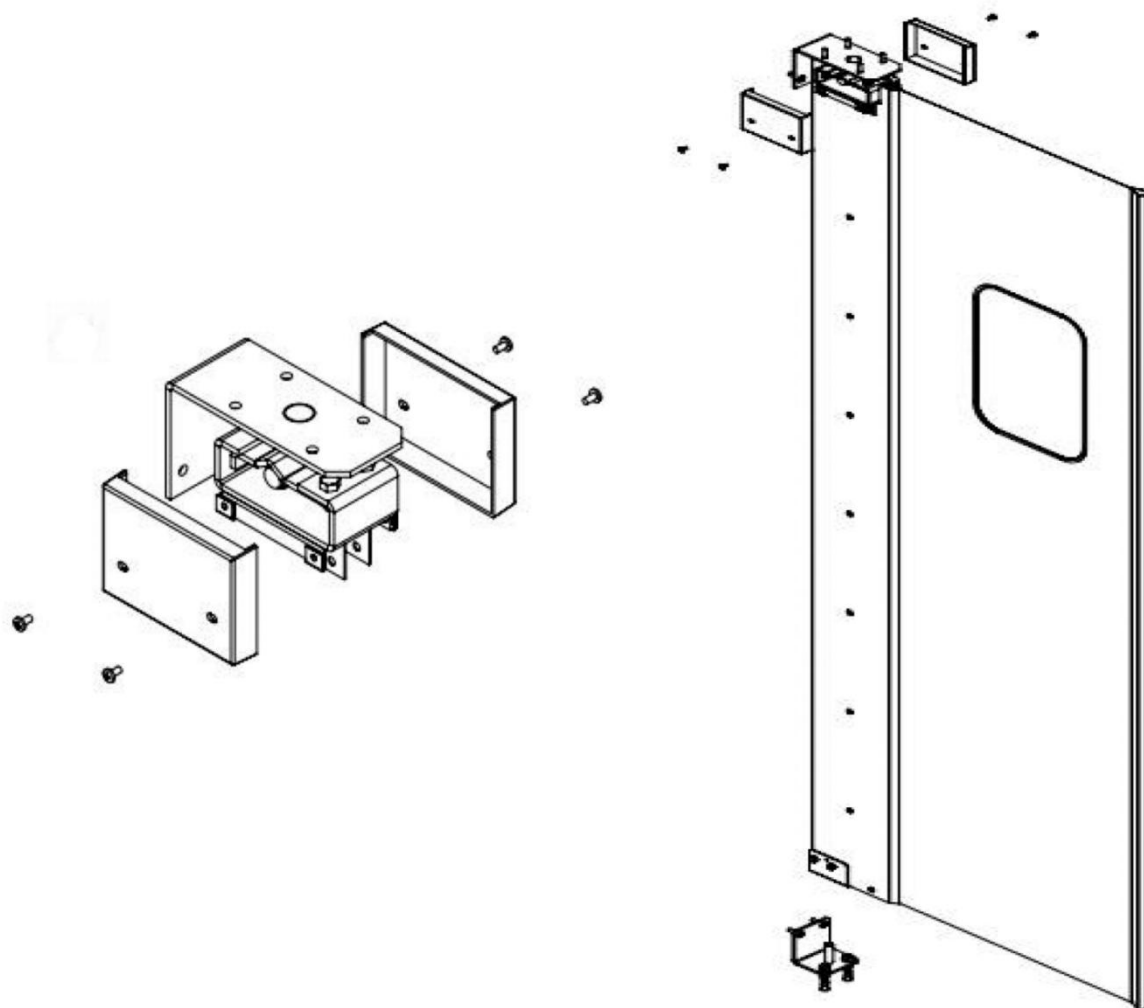

10. Align the door in such a way that the lower pin receptacle on the bottom of the door is placed onto the pin attached to the lower "L" bracket.

11. Next, place the top hinge assembly in a position where it sits on top of the cam bar.

12. Reinstall the 2 nuts and bolts that were previously removed in Step 1. Do not completely tighten until the door panel is totally aligned. Check next step 13, for further instruction.

13. Reposition the door panel within the opening by adjusting its position both front-to-back and side-by-side until it is as desired. Loosen the screws, including set screws, to align the bottom hinge saddle and make necessary side-to-side adjustments to the door panel.

14. Once adjusted, tighten all screws and bolts securely.

15. Insert and screw **(4) cross head screw(#10-32\*0.375)** to mount **(2) side cover** for the upper hinge assembly.

16. Same for the other side if needed. Ensure that the two doors create a tight seal in the middle when closed.

### 3. PARTS(1 Set/Door)

Side Cover



Side Cover



2 \* Expansion Bolts  
(3/8-16\*2.25)



6 \* Large Cross Head Bolts  
(1/4-20\*1)



4 \* Spare bolts



2 \* Cross  
Head Bolts  
(1/4-20\*1)



4 \* Cross Head bolts  
(#10-32\*0.375)